

LINE NO.	DOCUMENT NUMBER	DESCRIPTION	QTY.	LINE NO.	DOCUMENT NUMBER	DESCRIPTION	QTY.
1	2516	STUD FULLY THREADED 5/16-18X1.5"	2	1	2517	STUD FULLY THREADED M8-1.25X35MM	2
2	1196	NUT HEX 5/16-18	4	2	1200	NUT HEX M8-1.25	4
3	1194	WASHER FLAT 5/16"	4	3	1194	WASHER FLAT 5/16"	4
4	2513	BRACKET 1 FLANGE MOUNT DECOUPLER PLATED	2	4	2513	BRACKET 1 FLANGE MOUNT DECOUPLER PLATED	2
5	1195	WASHER SPLIT LOCK 5/16"	2	5	1195	WASHER SPLIT LOCK 5/16"	2
6	3041	TEF-GEL	1	6	3041	TEF-GEL	1

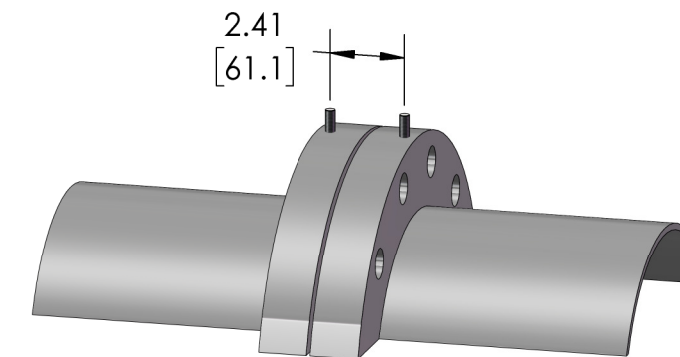

MTT KIT INSTALLATION INSTRUCTIONS:

- CENTER PUNCH MARK THE LOCATIONS FOR THE STUDS AS ILLUSTRATED.
- USE THE APPROPRIATE TAP DRILL SIZE FOR A 5/16 OR M8 STUD DEPENDING ON THE KIT ORDERED AND DRILL A VERTICAL HOLE ON THE TOP OF THE FLANGE $\approx 3/4"$ DEEP ($\approx 19\text{MM}$).
- TAP EACH HOLE AND CLEAN OUT THE CHIPS FROM THE TAPPING OPERATION.
- HAND THREAD A NUT ON ONE OF THE STUDS $\approx 5/8"$ FROM THE END, APPLY TEFGEL TO THE THREADS ON THE OTHER END OF THE STUD AND THREAD FULLY INTO EACH TAPPED HOLE. REPEAT FOR THE SECOND STUD.
- PLACE A FLAT WASHER OVER ONE OF THE STUDS FOLLOWED BY A MOUNTING BUS ORIENTED AS ILLUSTRATED, A SECOND FLAT WASHER, A SPLIT LOCK WASHER AND NUT. HAND TIGHTEN THE NUT. REPEAT FOR THE SECOND STUD.
- ASSEMBLE EACH MOUNTING BUS TO THE SSD OR OVP2 TERMINALS AS ILLUSTRATED USING THE TERMINAL HARDWARE PROVIDED IN THE WITH THE PRODUCT.
- IF NECESSARY, ADJUST THE TWO NUTS ON EACH STUD SO THE SSD OR OVP2 IS ORIENTED AS DESIRED AND THEN TIGHTEN ALL FOUR NUTS.

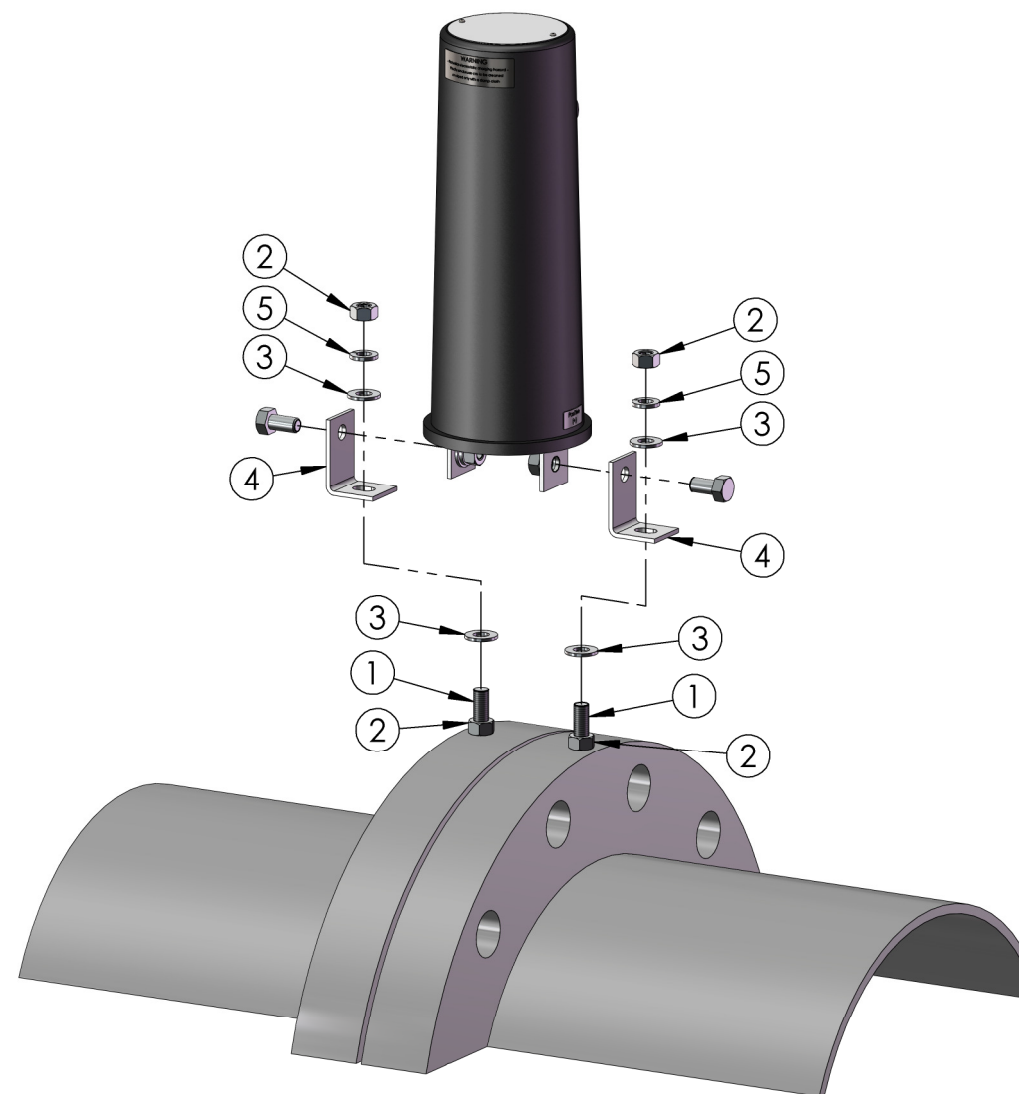

ANSI Y14.5M 1994 APPLIES
 UNLESS NOTED
 UNITS: INCHES
 3-PLACE: ± 0.005
 2-PLACE: ± 0.015
 1-PLACE / FRAC: ± 0.03
 ANGULAR: ± 1



DAIRYLAND ELECTRICAL INDUSTRIES, INC.
 P.O. BOX 187
 STOUGHTON, WI 53589
 608-877-9900
 DAIRYLAND.COM

DESCRIPTION MTS-MTT INSTALLATION				
DOCUMENT # 100049	REV B	DATE DRAWN 2014-01-21	DWG SIZE B	DATE APPROVAL 2019-03-14
SCALE 1:4	DRAWN: JPW	SHEET: 1 OF 2	DWG APPROVAL: JWV	

LINE NO.	DOCUMENT NUMBER	DESCRIPTION	QTY.
1	2513	BRACKET 1 FLANGE MOUNT DECOUPLER PLATED	2
2	3041	TEF-GEL	1

MTS KIT INSTALLATION INSTRUCTIONS

1. CENTER PUNCH MARK THE LOCATIONS FOR THE PIN BRAZED STUDS AS ILLUSTRATED.
2. PIN BRAZE AN 8mm STUD (USER FURNISHED) OVER EACH PUNCH MARK KEEPING THE STUDS VERTICAL AND PARALLEL TO EACH OTHER.
3. PLACE A FLAT WASHER (FURNISHED WITH THE PIN BRAZED STUD) OVER THE THREADED END OF EACH STUD FOLLOWED BY A MOUNTING BUS ORIENTED AS ILLUSTRATED, A SECOND FLAT WASHER, A SPLIT LOCK WASHER AND M8 NUT. HAND TIGHTEN THE NUT. REPEAT FOR THE SECOND STUD.
4. ASSEMBLE EACH MOUNTING BUS TO THE SSD OR OVP TERMINALS AS ILLUSTRATED USING THE TERMINAL HARDWARE PROVIDED IN THE WITH THE PRODUCT.
5. IF NECESSARY, ADJUST THE TWO NUTS ON EACH STUD SO THE SSD OR OVP2 IS ORIENTED AS DESIRED AND THEN TIGHTEN ALL FOUR NUTS.

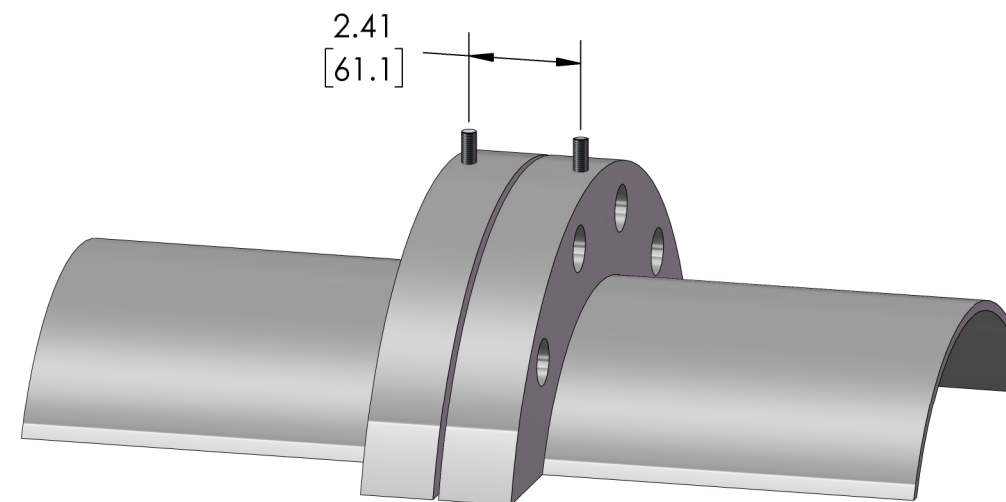
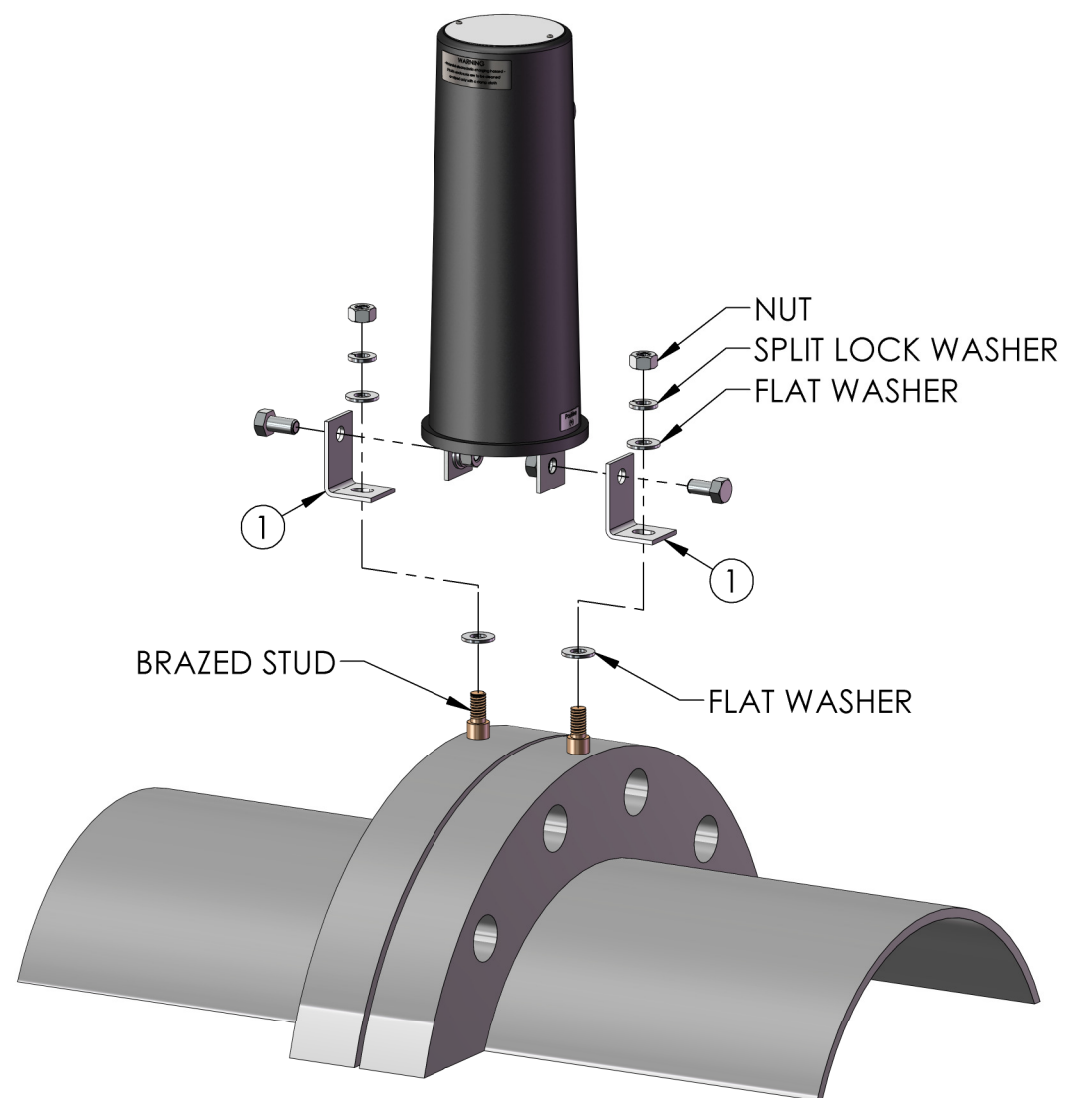

ANSI Y14.5M 1994 APPLIES
 UNLESS NOTED
 UNITS: INCHES
 3-PLACE: ±.005
 2-PLACE: ±.015
 1-PLACE / FRAC: ±.03
 ANGULAR: ±1

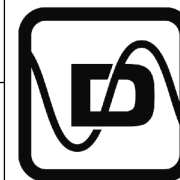

**DAIRYLAND
 ELECTRICAL
 INDUSTRIES, INC.**
 P.O. BOX 187
 STOUGHTON,
 WI 53589
 608-877-9900
 DAIRYLAND.COM

DESCRIPTION MTS-MTT INSTALLATION				
DOCUMENT # 100049	REV B	DATE DRAWN 2014-01-21	DWG SIZE B	DATE APPROVAL 2019-03-14
SCALE 1:4	DRAWN: JPW	SHEET: 2 OF 2	DWG APPROVAL: JWV	