

LINE NO.	DOCUMENT NUMBER	DESCRIPTION	QTY.
1	3056	CLAMP TOP GAS SENSE PLATED	1
2	3058	CLAMP BOTTOM GAS SENSE PLATED	1
3	3455	TERMINAL BOLTED HEX SOCKET HD #8-1/0 PLATED W/ MODIFIED SET SCREW	1
4	1013	WASHER FLAT 1/4"	8
5	1556	SCREW HEX 1/4-20X1.000"	3
6	1014	WASHER SPLIT LOCK 1/4"	3
7	1015	NUT HEX 1/4-20	3
8	3041	TEF-GEL	1

MTC-38 TUBING CLAMP KIT INSTALLATION INSTRUCTIONS:

THE MTC-38 TUBING CLAMP KIT IS DESIGNED FOR MAKING ELECTRICAL CONNECTIONS TO SMALL DIAMETER THIN-WALLED TUBING COMMONLY USED IN GAS INSTRUMENTATION LINES. THESE GAS LINES ARE OFTEN CONNECTED TO CATHODICALLY PROTECTED PIPELINES AND INSULATED FROM STATION GROUNDING SYSTEMS WITH AN INSULATED UNION SO AS NOT TO AFFECT PIPELINE CP LEVELS. TO PROVIDE OVER-VOLTAGE PROTECTION TO INSULATED UNIONS FROM LIGHTNING AND AC FAULTS, OR TO PROVIDE AC GROUNDING FOR THE CATHODICALLY PROTECTED SIDE OF THE GAS LINE WITHOUT AFFECTING CP LEVELS, IT IS SOMETIMES NECESSARY TO MAKE ELECTRICAL CONNECTIONS TO THESE SMALL LINES.

1. TO PROVIDE OVER-VOLTAGE PROTECTION ACROSS AN INSULATED UNION, CONNECTIONS SHOULD BE MADE AS CLOSE AS POSSIBLE ON EACH SIDE OF THE UNION AND CONNECTED TO THE PROTECTIVE DEVICE WITH THE SHORTEST POSSIBLE LEADS. PARTICULARLY WHEN THE OBJECTIVE IS TO PROVIDE OVER-VOLTAGE PROTECTION FROM LIGHTNING. A CONNECTOR IS PROVIDED WITH THE CLAMP FOR A CONDUCTOR SIZE FROM #8 AWG TO 1/0. LEADS ARE TO BE FURNISHED BY THE USER.
2. CONFIRM THAT THE PROTECTIVE DEVICE CHOSEN HAS A HAZARDOUS LOCATION CERTIFICATION SUITABLE FOR THE APPLICATION AREA.
3. FOR CONNECTIONS TO THE SMALL GAS LINE, APPLY THE TEFGEL CORROSION INHIBITOR PROVIDED TO THE INSIDE SURFACES OF THE MTC-38 CLAMP. ATTACH THE CLAMP TO THE TUBING AND TIGHTEN THE CLAMPING NUT TO THE EXTENT POSSIBLE WITHOUT DISTORTING THE TUBING.
4. SOME APPLICATIONS MAY REQUIRE AN MTC-38 CLAMP ON THE SMALL TUBING ON EACH SIDE OF THE INSULATED UNION BUT OTHER APPLICATIONS MAY HAVE THE INSULATED UNION AT THE TRANSITION TO A LARGER DIAMETER PIPE WHERE A DIFFERENT MEANS OF CONNECTION IS REQUIRED. ILLUSTRATED IS AN APPLICATION IN A CLASS I, DIV.1 AREA WHERE THE PROTECTIVE DEVICE SELECTED WAS AN OVP THAT WAS CONNECTED ACROSS AN INSULATED UNION WITH A SMALL GAS LINE ON ONE SIDE AND 1" DIAMETER PIPE ON THE OTHER.

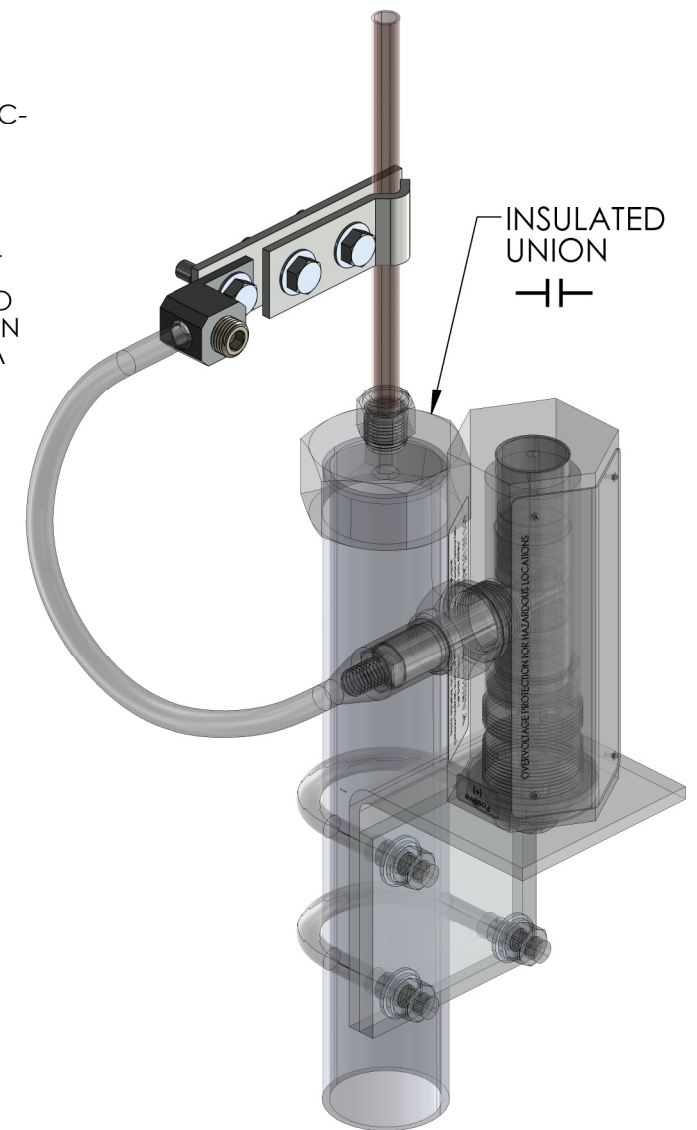
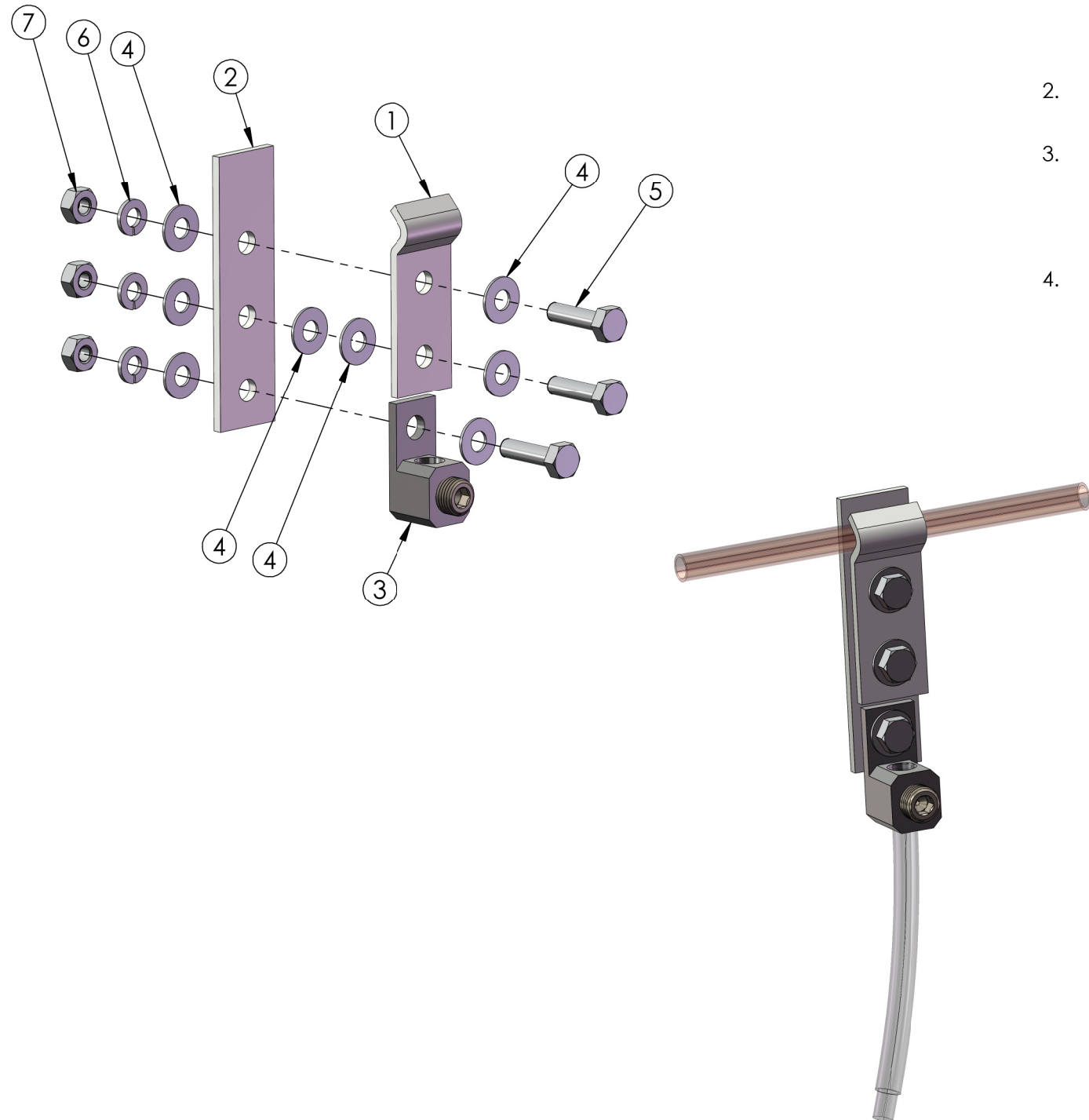

ANSI Y14.5M 1994 APPLIES
 UNLESS NOTED
 UNITS: INCHES
 3-PLACE: ±.005
 2-PLACE: ±.015
 1-PLACE / FRAC: ±.03
 ANGULAR: ±1

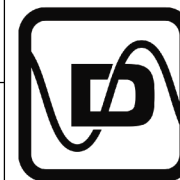

**DAIRYLAND
 ELECTRICAL
 INDUSTRIES, INC.**
 P.O. BOX 187
 STOUGHTON,
 WI 53589
 608-877-9900
 DAIRYLAND.COM

DESCRIPTION TUBING CLAMP INSTALLATION				
DOCUMENT # 100050	REV B	DATE DRAWN 2014-02-10	DWG SIZE B	DATE APPROVAL 2019-03-14
SCALE 1:2	DRAWN: JPW	SHEET: 1 OF 1	DWG APPROVAL: JWV	